

ANANTARA ALPINES

THE  
**COURTYARD**  
APARTMENTS

AN ARRAY OF  
— **LIFESTYLES** —  
UNDER ONE ROOF



# 2<sup>ND</sup> BASEMENT PLAN

ADJ. F.P. NO: 199  
SALE FOR RESIDENTIAL  
61.52M

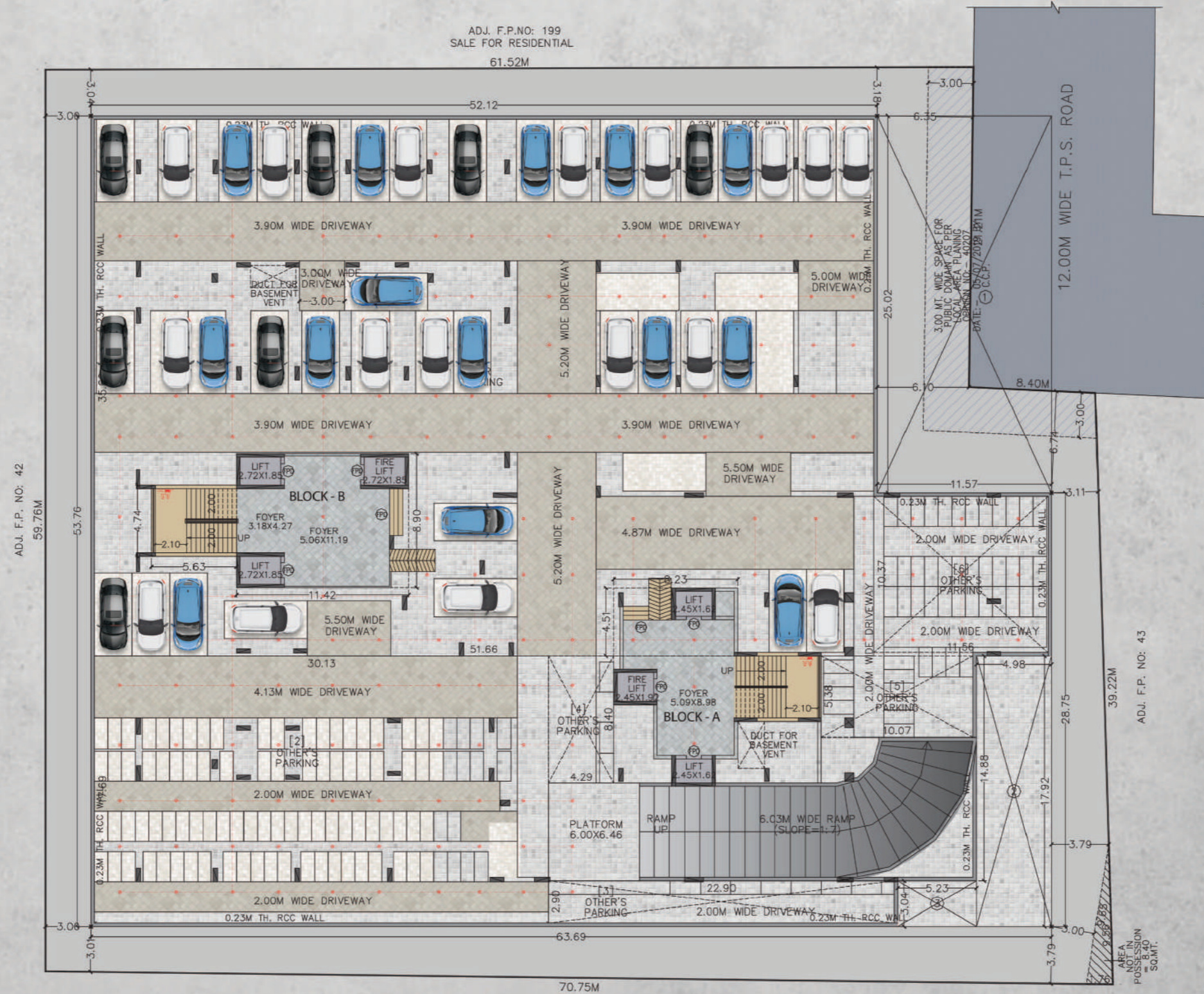

ADJ. F.P. NO: 42  
59.76M

ADJ. F.P. NO: 43  
39.22M

70.75M  
ADJ. F.P. NO: 42



AREA IN POSSESSION = 8.40 SQ.MT.





# BLOCK - A - LAYOUT PLAN



BLOCK - A - 101 - 1001



FLOOR'S	UNITS	BUILT UP AREA. (SQ.MT.)	CARPET AREA (AS PER RERA) (SQ.MT.)	BALCONY (SQ.MT.)	WASH AREA (SQ.MT.)	TOTAL RERA BUILT UP AREA. (SQ.MT.)
1 <sup>st</sup> to 10 <sup>th</sup>	101 to 1001	210.50	188.23	11.91	3.97	204.11

BLOCK - A - 102 - 1002



FLOOR'S	UNIT'S	BUILT UP AREA. (SQ.MT.)	CARPET AREA (AS PER RERA) (SQ.MT.)	BALCONY (SQ.MT.)	WASH AREA (SQ.MT.)	TOTAL RERA BUILT UP AREA. (SQ.MT.)
1 <sup>st</sup> to 10 <sup>th</sup>	102 to 1002	220.61	196.33	11.91	5.24	213.48



Block - A 104  
1<sup>st</sup> floor, Deck 6'0" x 25'2 1/2"



FLOOR'S	UNIT'S	BUILT UP AREA. (SQ.MT.)	CARPET AREA (AS PER RERA) (SQ.MT.)	BALCONY (SQ.MT.)	WASH AREA (SQ.MT.)	TERRACE (SQ.MT.)	TERRACE (SQ.FT.)	TOTAL RERA BUILT UP AREA. (SQ.MT.)
1 <sup>st</sup>	104	233.13	188.23	20.31	3.97	5.04	54.25	217.55



Block - A - 404, 704 and 1004  
4<sup>th</sup>, 7<sup>th</sup>, and 10<sup>th</sup>, floor, Balcony 6'0" x 15'9"

Block - A - 304, 604 and 904  
3<sup>rd</sup>, 6<sup>th</sup>, and 9<sup>th</sup>, floor, Balcony 6'0" x 15'9"

Block - A 204, 504 and 804  
2<sup>nd</sup>, 5<sup>th</sup>, and 8<sup>th</sup>, floor, Balcony 6'0" x 15'9"



FLOOR'S	UNIT'S	BUILT UP AREA. (SQ.MT.)	CARPET AREA (AS PER RERA) (SQ.MT.)	BALCONY (SQ.MT.)	WASH AREA (SQ.MT.)	TOTAL RERA BUILT UP AREA. (SQ.MT.)
2 <sup>nd</sup> , 5 <sup>th</sup> , and 8 <sup>th</sup>	204, 504 and 804	219.75	188.23	20.31	3.97	212.51
3 <sup>rd</sup> , 6 <sup>th</sup> , and 9 <sup>th</sup>	304, 604 and 904	219.75	188.23	20.31	3.97	212.51
4 <sup>th</sup> , 7 <sup>th</sup> , and 10 <sup>th</sup>	404, 704 and 1004	219.75	188.23	20.31	3.97	212.51



Block - A 103  
1<sup>st</sup> floor, Deck - 6'00 x 25'2 1/2"



FLOOR'S	UNIT'S	BUILT UP AREA. (SQ.MT.)	CARPET AREA (AS PER RERA) (SQ.MT.)	BALCONY (SQ.MT.)	WASH AREA (SQ.MT.)	TERRACE (SQ.MT.)	TERRACE (SQ.FT.)	TOTAL RERA BUILT UP AREA. (SQ.MT.)
1 <sup>st</sup>	103	235.72	206.71	15.56	5.24	7.90	85.03	235.41



FLOOR'S	UNIT'S	BUILT UP AREA. (SQ.MT.)	CARPET AREA (AS PER RERA) (SQ.MT.)	BALCONY (SQ.MT.)	WASH AREA (SQ.MT.)	TOTAL RERA BUILT UP AREA. (SQ.MT.)
2 <sup>nd</sup> , 5 <sup>th</sup> , and 8 <sup>th</sup>	203, 503 and 803	235.72	206.71	15.56	5.24	227.51
3 <sup>rd</sup> , 6 <sup>th</sup> , and 9 <sup>th</sup>	303, 603 and 903	230.78	206.71	10.89	5.24	222.84
4 <sup>th</sup> , 7 <sup>th</sup> , and 10 <sup>th</sup>	403, 703 and 1003	230.78	206.71	10.89	5.24	222.84



BLOCK - B - 101 - 1001



FLOOR'S	UNIT'S	BUILT UP AREA. (SQ.MT.)	CARPET AREA (AS PER RERA) (SQ.MT.)	BALCONY (SQ.MT.)	WASH AREA (SQ.MT.)	TOTAL RERA BUILT UP AREA. (SQ.MT.)
1* to 10*	101 to 1001	231.63	208.39	11.91	3.85	224.15

Block - B 102  
1st floor, Deck 5'2" x 5'6"



FLOOR'S	UNIT'S	BUILT UP AREA. (SQ.MT.)	CARPET AREA (AS PER RERA) (SQ.MT.)	BALCONY (SQ.MT.)	WASH AREA (SQ.MT.)	TERRACE (SQ.MT.)	TERRACE SQ. FT.	TOTAL RERA BUILT UP AREA. (SQ.MT.)
1 <sup>st</sup>	102	239.26	200.01	26.59	3.85	14.53	156.40	244.98

Block - B - 402, 702 and 1002  
4<sup>th</sup>, 7<sup>th</sup>, and 10<sup>th</sup>, floor, Balcony 5'9" x 14'1"

Block - B - 302, 602 and 902  
3<sup>rd</sup>, 6<sup>th</sup>, and 9<sup>th</sup>, floor, Balcony 5'9" x 15'9"

Block - B - 202, 502 and 802  
2<sup>nd</sup>, 5<sup>th</sup>, and 8<sup>th</sup>, floor, Balcony 5'9" x 15'9"

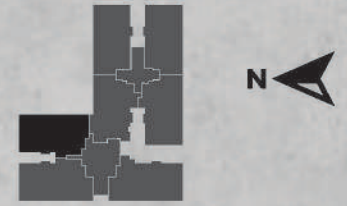

FLOOR'S	UNIT'S	BUILT UP AREA. (SQ.MT.)	CARPET AREA (AS PER RERA) (SQ.MT.)	BALCONY (SQ.MT.)	WASH AREA (SQ.MT.)	TOTAL RERA BUILT UP AREA. (SQ.MT.)
2 <sup>nd</sup> , 5 <sup>th</sup> , and 8 <sup>th</sup>	202, 502 and 802	232.60	200.01	20.31	3.85	224.17
3 <sup>rd</sup> , 6 <sup>th</sup> , and 9 <sup>th</sup>	302, 602 and 902	232.60	200.01	20.31	3.85	224.17
4 <sup>th</sup> , 7 <sup>th</sup> , and 10 <sup>th</sup>	402, 702 and 1002	231.49	200.01	19.26	3.85	223.12

BLOCK - B - 103, 1003



FLOOR'S	UNIT'S	BUILT UP AREA (SQ.MT.)	CARPET AREA (AS PER RERA) (SQ.MT.)	BALCONY (SQ.MT.)	WASH AREA (SQ.MT.)	TOTAL RERA BUILT UP AREA (SQ.MT.)
1 <sup>st</sup> to 10 <sup>th</sup>	103 to 1003	23.280	208.03	11.91	5.46	225.40

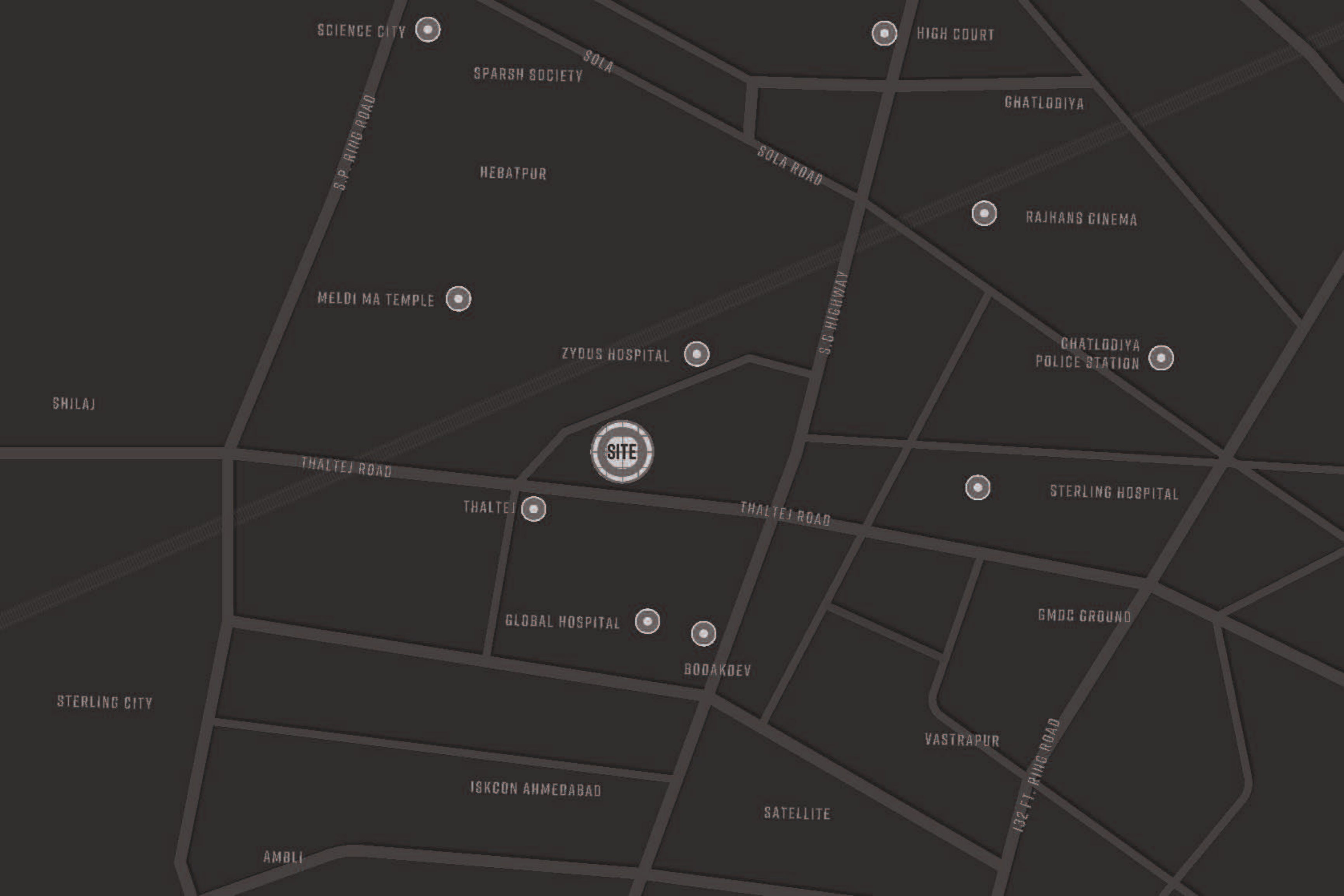

SCIENCE CITY

HIGH COURT

SPARSH SOCIETY

GHATLODIYA

HEBATPUR

RAJHANS CINEMA

MELDI MA TEMPLE

ZYODUS HOSPITAL

GHATLODIYA  
POLICE STATION

SHILAJ

SITE

THALTEJ ROAD

STERLING HOSPITAL

THALTEJ

THALTEJ ROAD

GLOBAL HOSPITAL

GMDC GROUND

BODAKDEV

STERLING CITY

VASTRAPUR

ISKCON AHMEDABAD

SATELLITE

AMBLI

132 FT. RING ROAD

## **PROJECT SPECIFICATIONS**

### **FRAME STRUCTURE**

RCC FRAME WITH SAND BASED BLOCKS

### **FLOORING**

ITALIAN MARBLE FLOORING IN DRAWING ROOM, DINING, COMMON PASSAGE & PREMIUM TILE FLOORING IN BEDROOMS & BATHROOMS

### **WATER SUPPLY**

COMMON UNDERGROUND WATER TANK FOR DOMESTIC WATER USE  
OVERHEAD WATER TANK WITH PRESSURIZED SUPPLY

### **BATHROOMS**

ALL BATHROOMS WITH ANTI SKID TILES & PREMIUM WALL TILES  
BRANDED BATH & SANITARY FITTINGS (KOHLER OR EQUIVALENT)

### **WINDOWS & DOORS**

POWDER-COATED/ANODIZED ALUMINUM WINDOWS WITH DGU GLASS  
SOLID WOOD FLUSH DOORS

### **STORAGE**

DEDICATED STORE AREA IN KITCHEN

### **ELECTRICAL**

CONCEALED WIRING WITH ISI MATERIAL & SWITCHES FROM BRANDS  
(SCHNEIDER, LEGRAND OR EQUIVALENT)  
100% POWER BACKUP FOR COMMON SERVICES  
AC PIPING PROVISION IN ALL ROOMS

### **ELEVATOR**

2 PASSENGER ELEVATORS & 1 STRETCHER-SIZED SERVICE  
ELEVATOR PER BLOCK

### **SECURITY SYSTEM**

CCTV SURVEILLANCE SYSTEM  
VIDEO DOOR PHONE SYSTEM WITH INTERCOM  
DIGITAL DOOR LOCKS ON THE MAIN DOOR  
ROUND THE CLOCK SECURITY PERSONNEL

**A.SHRIDHAR**  
BUILDING THOUGHTFULLY





**ANANTARA ALPINES**

A.SHRIDHAR WAS FORMED WITH THE VISION OF BECOMING A BENCHMARK IN THE FIELD OF THE CONSTRUCTION INDUSTRY IN AHMEDABAD CITY. THE COMPANY IS BASED ON THE FOUNDATION OF ETHICS, QUALITY, AND TRANSPARENCY. WITH THE REMARKABLE EXPERIENCE OF MORE THAN 2 DECADES INLAND AND INFRASTRUCTURE DEVELOPMENT, WE AIM TO PROVIDE TECHNICAL, STRATEGIC, AND COMMERCIAL EXPERTISE WITH A BROAD RANGE OF REAL ESTATE PROJECTS.

**DEVELOPED BY: A.SHRIDHAR BUILDCON, A.SHRIDHAR CORPORATE HOUSE, NR KAVERI SANGAM, SHILAJ CIRCLE, S.P.RING ROAD, SHILAJ, AHMEDABAD.**

**ARCHITECT: SOURABH VERMA, 9TH STREET ARCHITECTS | STRUCTURAL CONSULTANT: ACHAL PARIKH**

**SITE ADDRESS: 13, MENAKA SOCIETY, THALTEJ AHMEDABAD, GUJARAT 380059**

**8306 333 777 | WWW.ASHRIDHAR.COM | KAVERI@ASHRIDHAR.COM |   | DOWNLOAD "A.SHRIDHAR" APP FROM  **



RERA REGISTRATION NO. \_\_\_\_\_  
WWW.GUJRERA.GUJARAT.GOV.IN

#### **Terms & Conditions**

All the architectural and interior images in the brochure, are merely simulated interpretations using computer graphics to enhance the customer understanding and are not factual images • The color and general appearance of the flooring and wall ties, sanitary ware & fittings walls, ceilings, windows, doors, internal roads, trees, shrubbery etc. shown in the simulated computer graphics images are taken from the object libraries for the purpose of presentation and the prospective buyers of the concerned property are advised to refer to the construction specifications mentioned in the brochure. Additional amenities and/or utilities not mentioned or shown in the brochure but may be required as per the law, should be deemed to be forming part of the project by the purchaser. • All furniture including wardrobes, other sofa furnishings inter-alia curtains, mattresses, bed linen, upholstery etc., lights and other electrical fixtures and appliances like air conditioners, refrigerators, TV's, telephones, laptops etc., any of the equipment, household accessories inter alia crockery and cutlery, rugs, carpets, decorative pieces and wall hangings, wall papers, utensils etc., apparels and all other consumable and movable items shown in the simulated images do not form part of the sale of any property by the developer. • All rights are reserved with the developers to make any changes in the project and all the members shall abide by such changes • GST, stamp duty, registration charges, or any other charges and taxes as & when levied by government or any of its body shall be borne by purchaser/buyer/legal possession holder • This brochure is not to be treated as part of the legal document and is for an easy display of the project. Subject to Ahmedabad Jurisdiction only • The Brochure is for restricted private circulation only and is not to be considered as a legal document with obligations for specific performance. It is meant for the purpose of conceptual presentation only.